

# LS2-F53A

パーツブック  
PARTS BOOK

---

一本針本縫総合送り水平釜ミシン<返し縫い付>

SINGLE NEEDLE UNISON FEED LOCK STITCHER WITH HORIZONTAL  
ROTARY HOOK AND REVERSE STITCHING

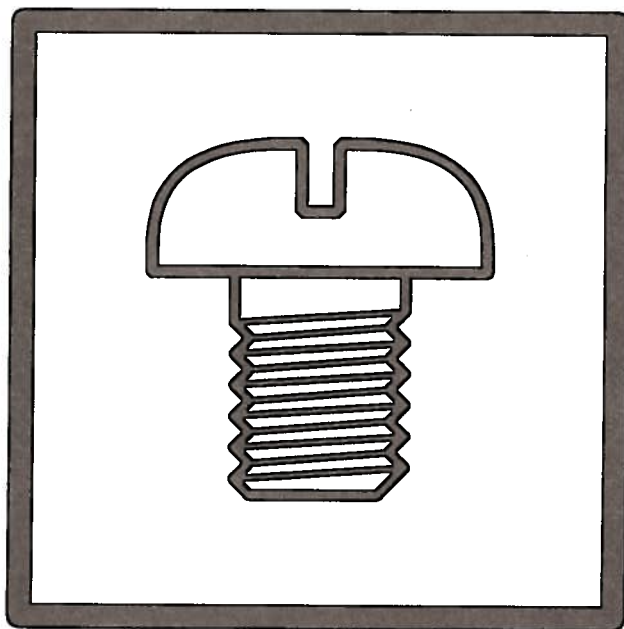

---

brother®



# 1. 糸調子・針板関係 / Thread tension, Needle plate

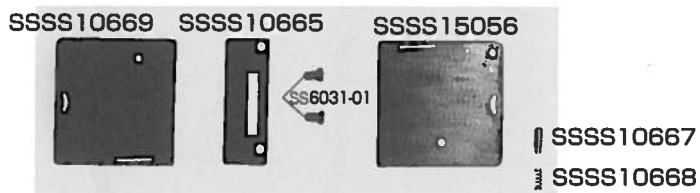
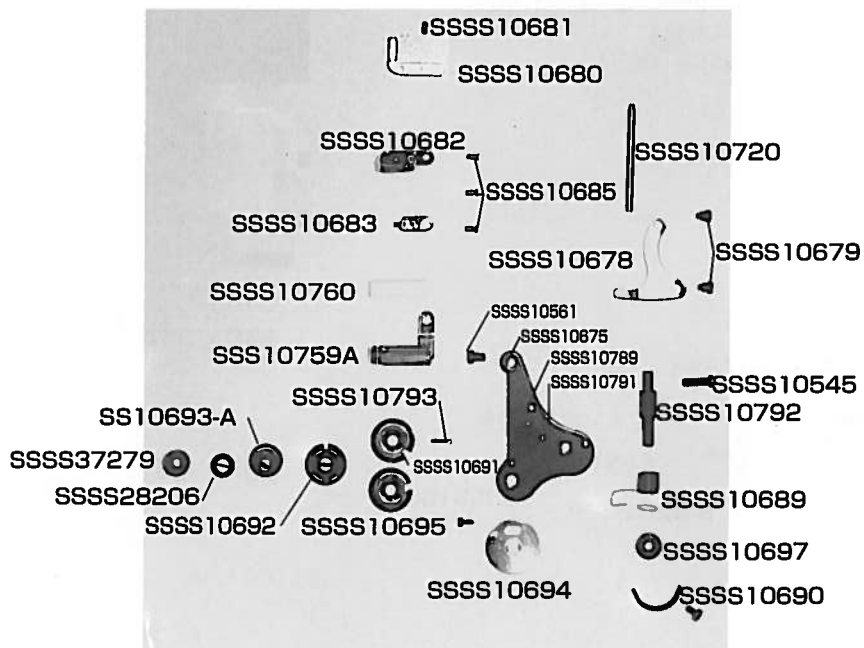

## 2. 上軸・天秤関係 / Upper shaft, Thread take-up

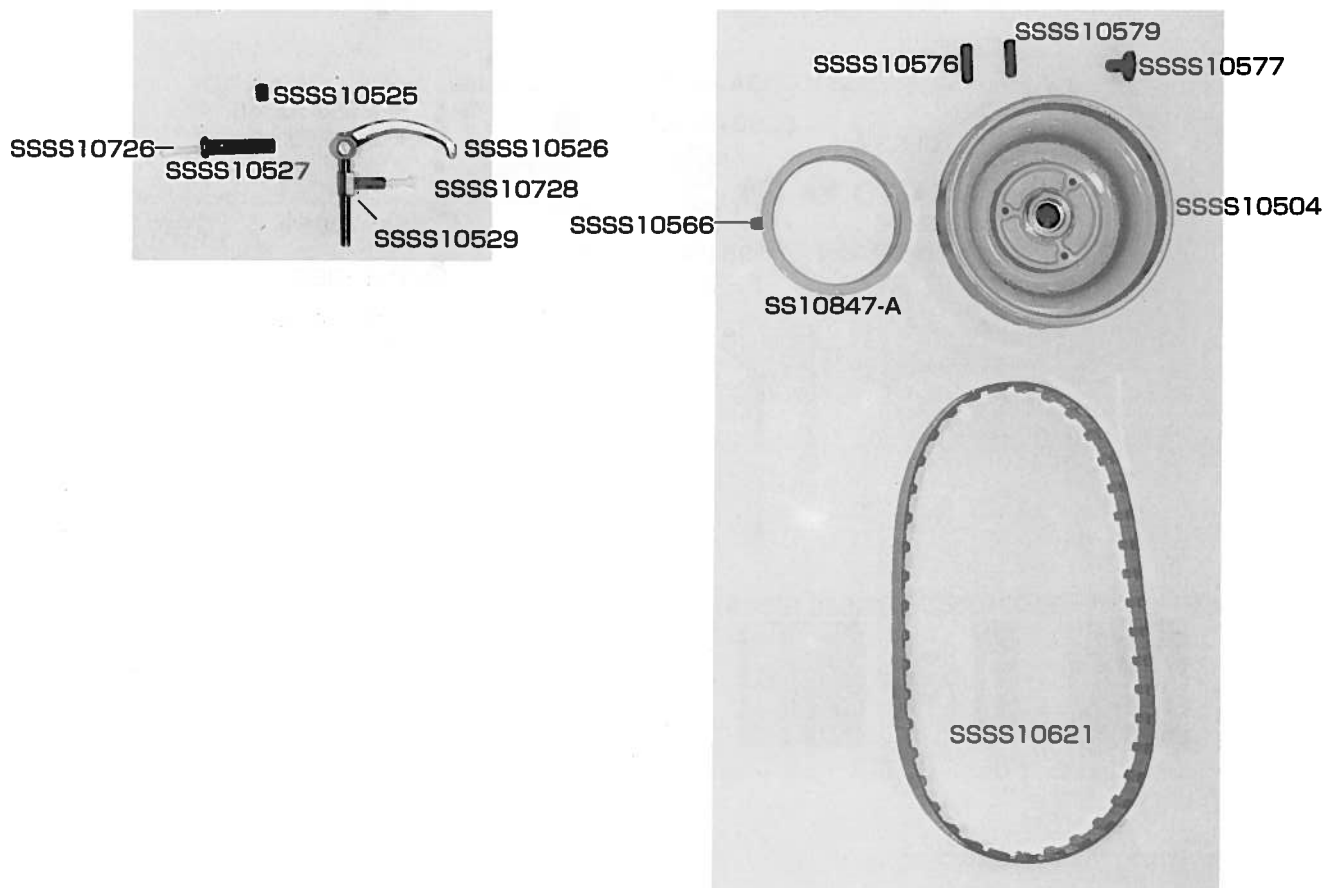
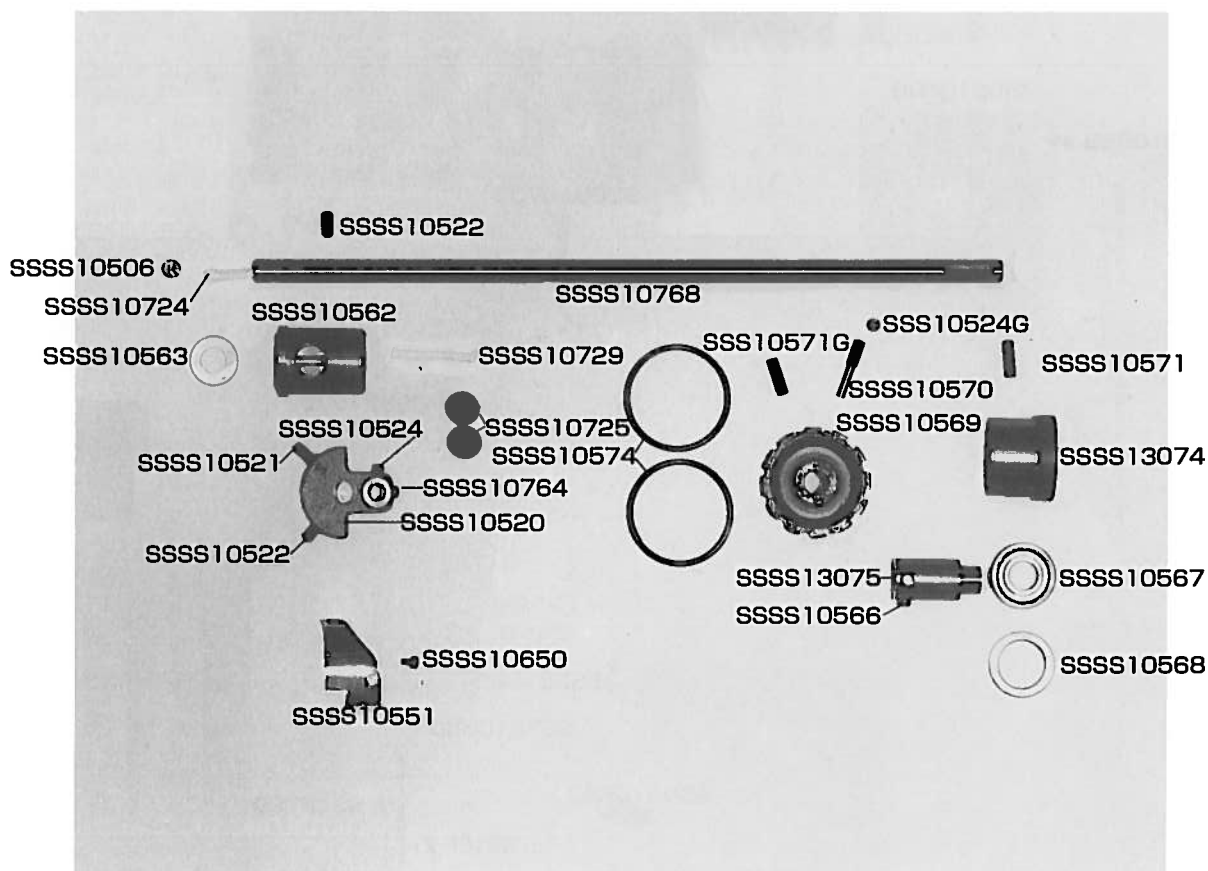

### 3. 針棒・上送り関係 / Needle bar, Upper feed Mechanism

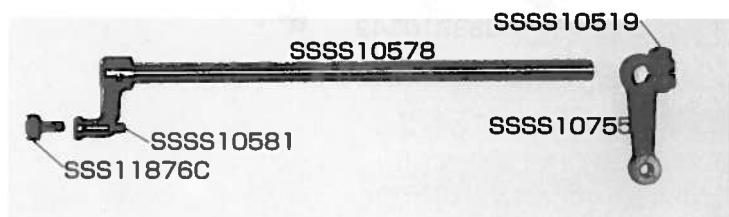
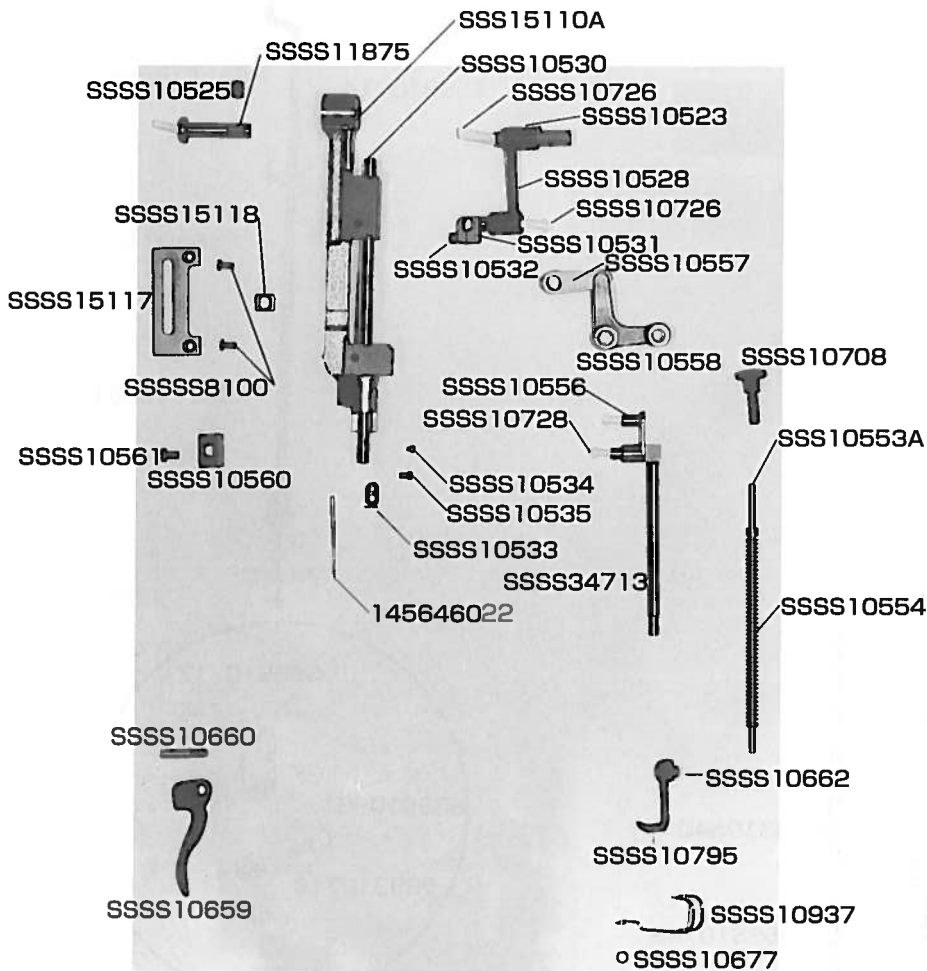
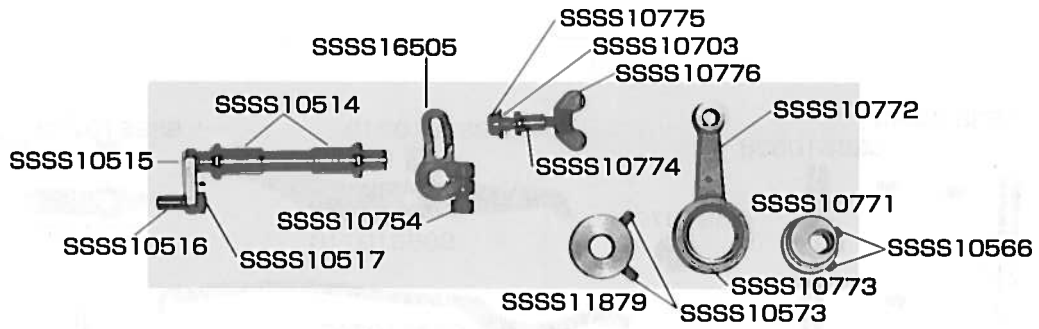

# 4. 押え関係 / Presser foot Mechanism

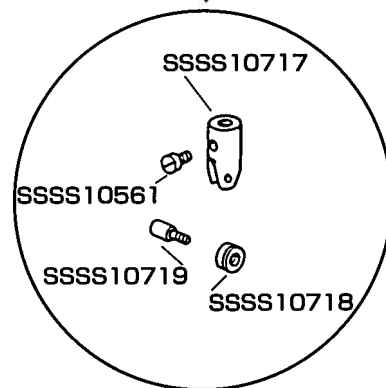
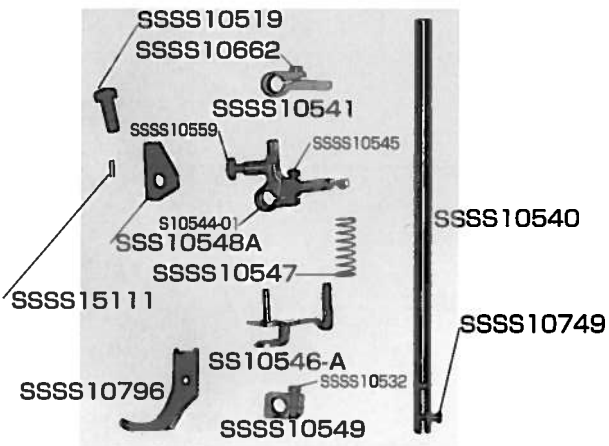
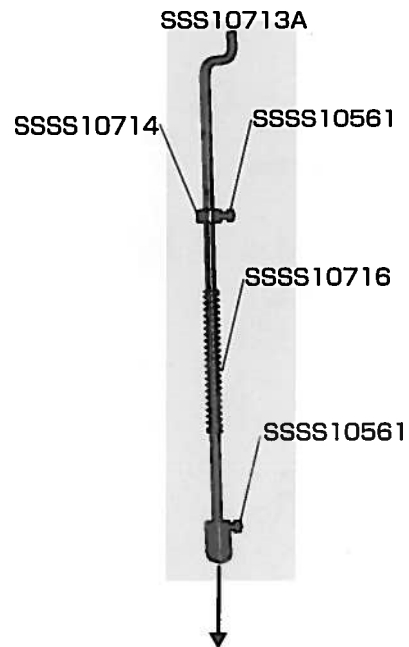
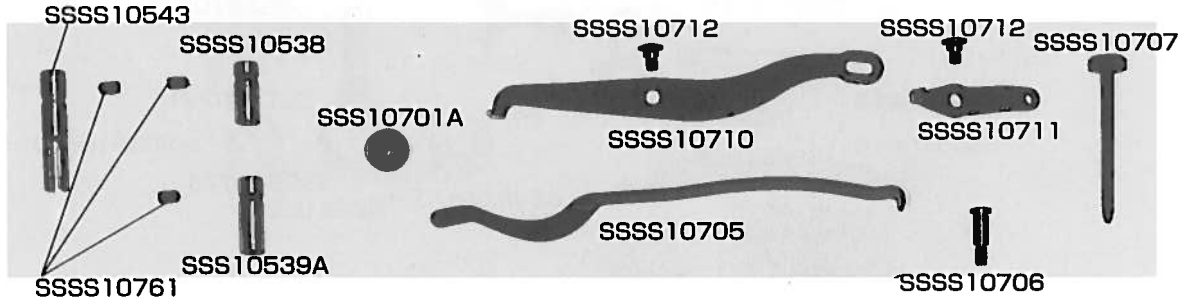

# 5. 下送り関係 / Lower feed Mechanism

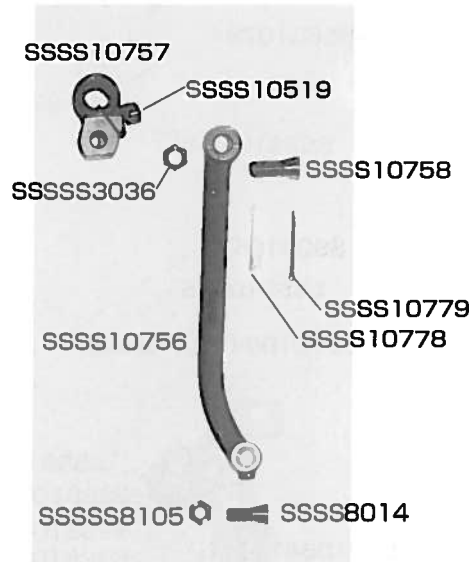
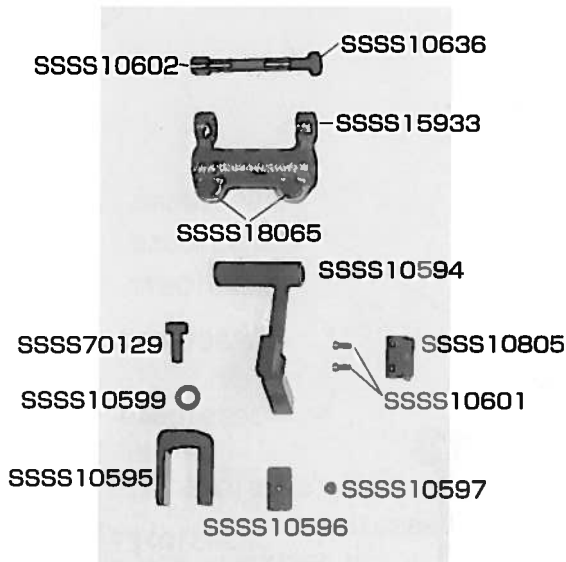
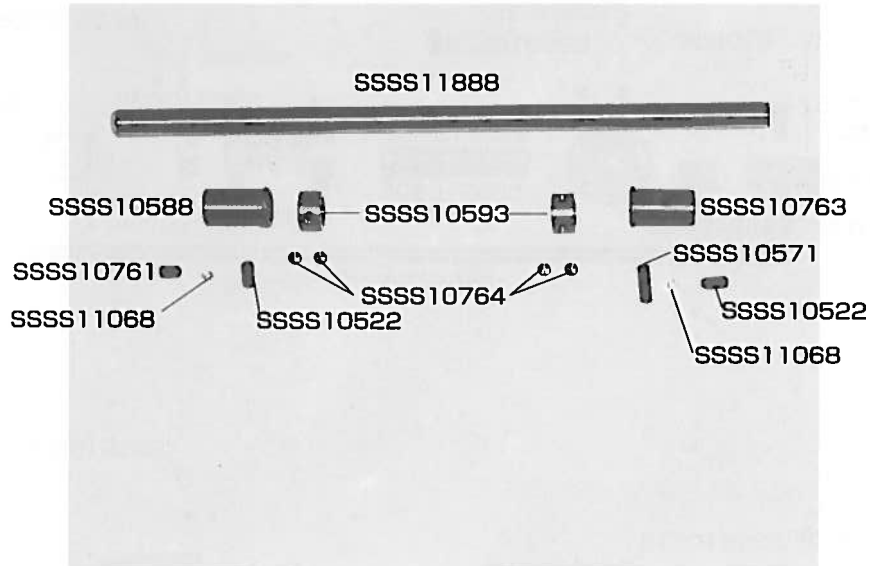

## 6. 下軸関係 / power shaft Mechanism

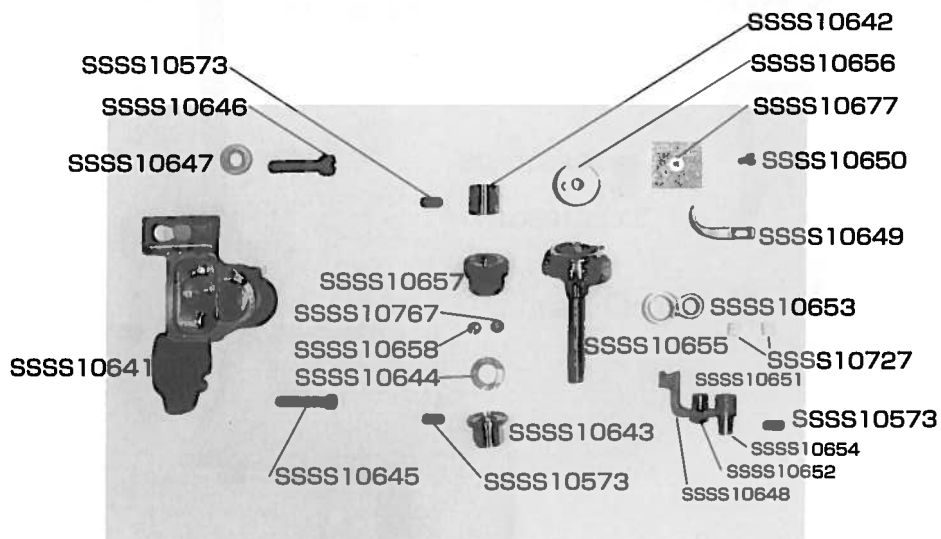
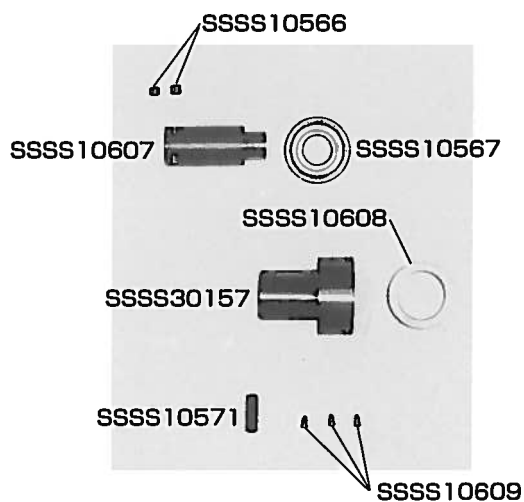
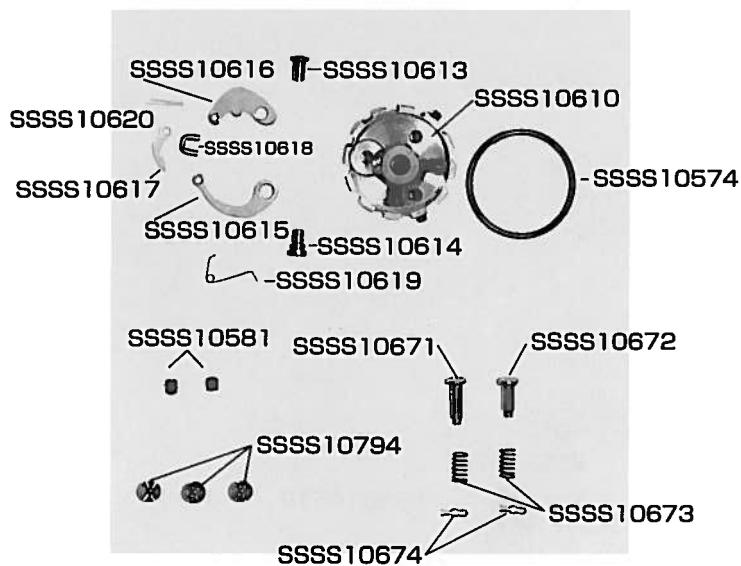
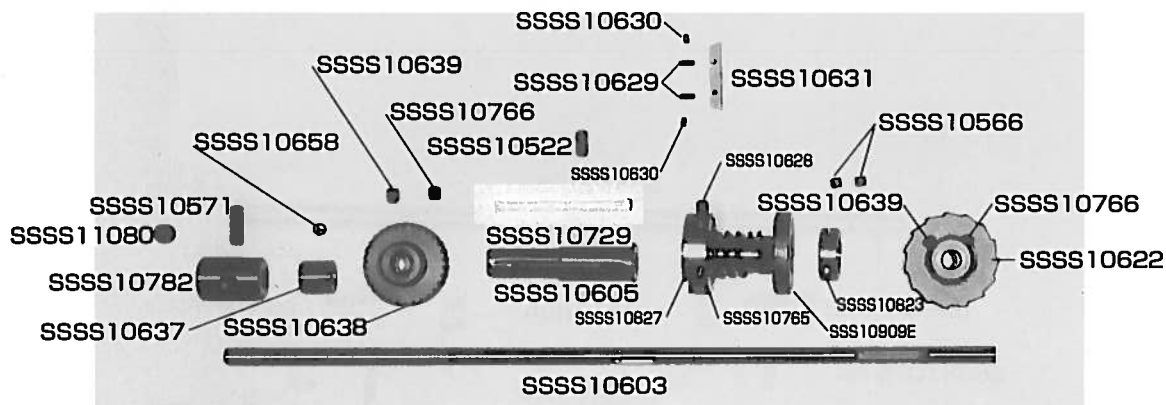



# 7. 返し縫い関係 / Reversing Mechanism

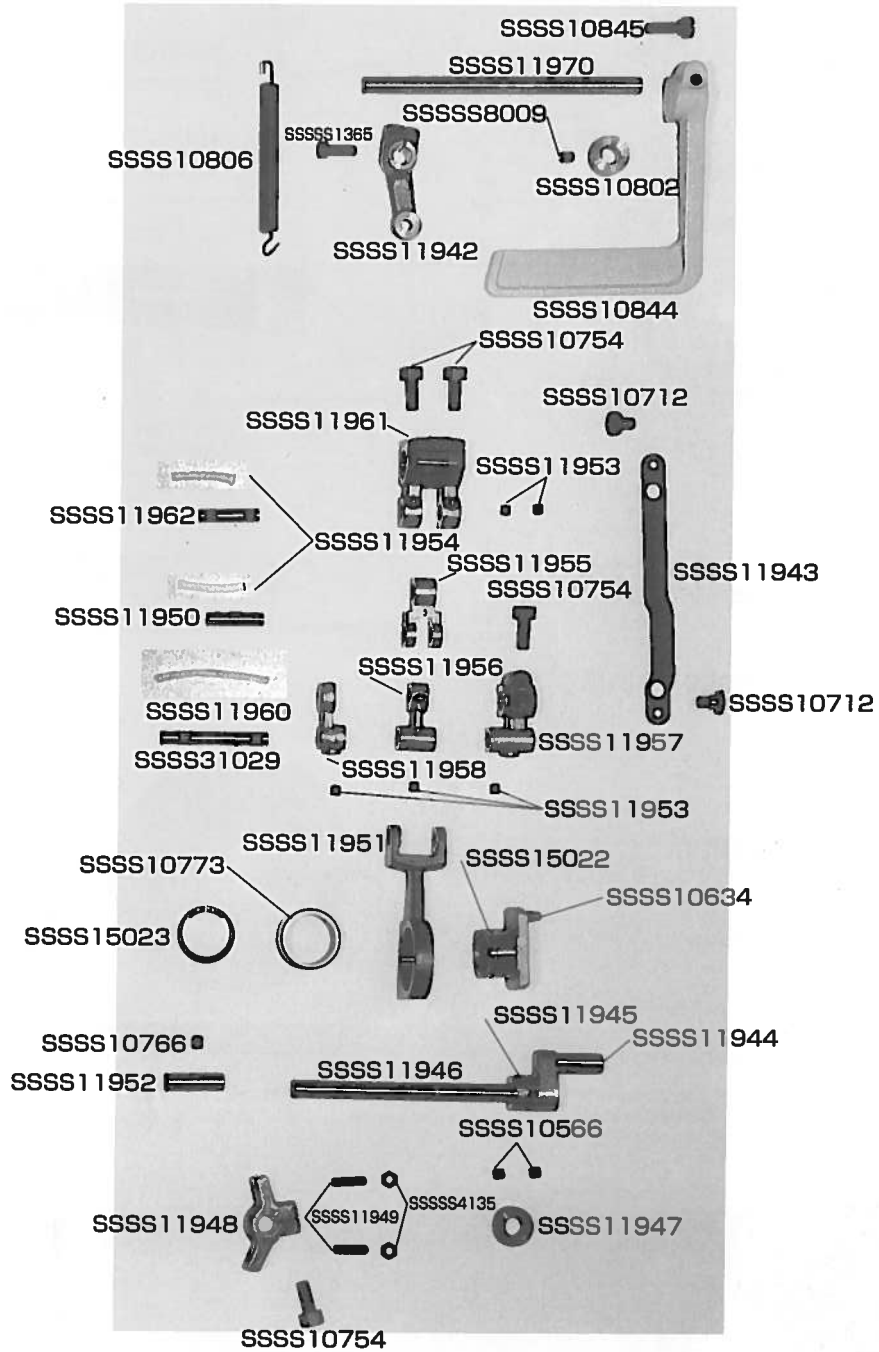

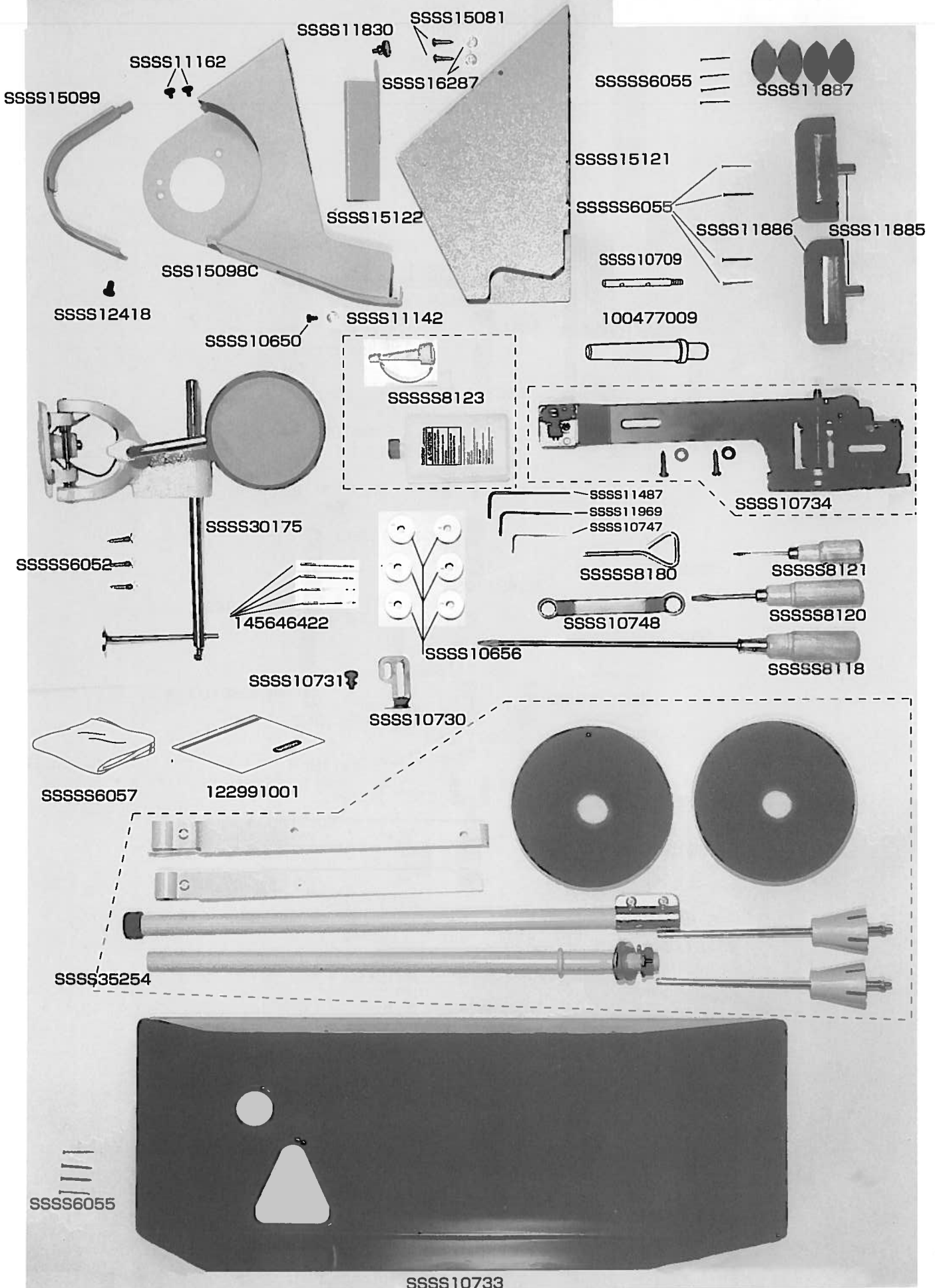

# 8. ベルトガード・付属品関係/Belt guard, Accessories

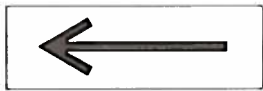

From the library of: Diamond Needle Corp

警告ラベル / Warning labels / Warnschilder  
 / Etiquettes d'avertissement / Etiquetas de advertencia

	品名 / Name of part	Size(mm)	Code
	ワーニングマーク Mark, injury	L=16 R=0.8	S36924-001
	矢印マーク Mark, arrow	10 × 30	S37058-001
	アースマーク Mark, grounding	φ 12	S37060-001
	Label, operation Eng.	40 × 64	S38349-001

brother®

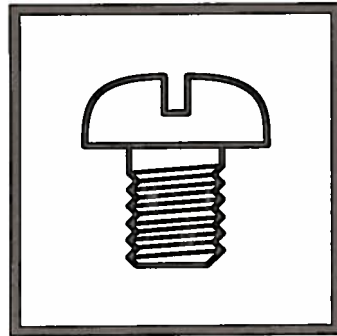

パーツブック  
PARTS BOOK

**ブラザー工業株式会社**

BROTHER INDUSTRIES, LTD.

〒467 名古屋市瑞穂区河岸1丁目1番1号 TEL (052) 824-2392 (代)

Printed in Japan

F53A  
S9553A-001  
1995.12H ①